

- NOTES
1. CABLE TRAY SIZES FOR THE PANEL BOARDS WAS TAKEN FROM THE MAXIMUM SIZE OF CABLE OF THE EXPECTED LOAD
 2. HEIGHT OF THE PANEL BOARDS (DB'S) SHALL BE 1800mm TOP OF THE BOX FROM FINISH FLOORING AS PER APPROVED GENERAL NOTES & LEGEND DRAWING.
 3. ALL DIMENSION IN mm OTHER WISE INDICATED.

- ELECTRICAL LEGEND:
- [Symbol] POWER CABLE TRAY, SIZE VARIES
 - [Symbol] DISCONNECT SWITCH NON FUSE FOR AHU'S & EXHAUST FAN RATING & POLE INDICATED ON THE DRAWING.
 - [Symbol] NORMAL SUPPLY
 - [Symbol] PANEL BOARD NAME
 - [Symbol] PANEL BOARD NUMBER
 - [Symbol] FEEDER NUMBER (1)

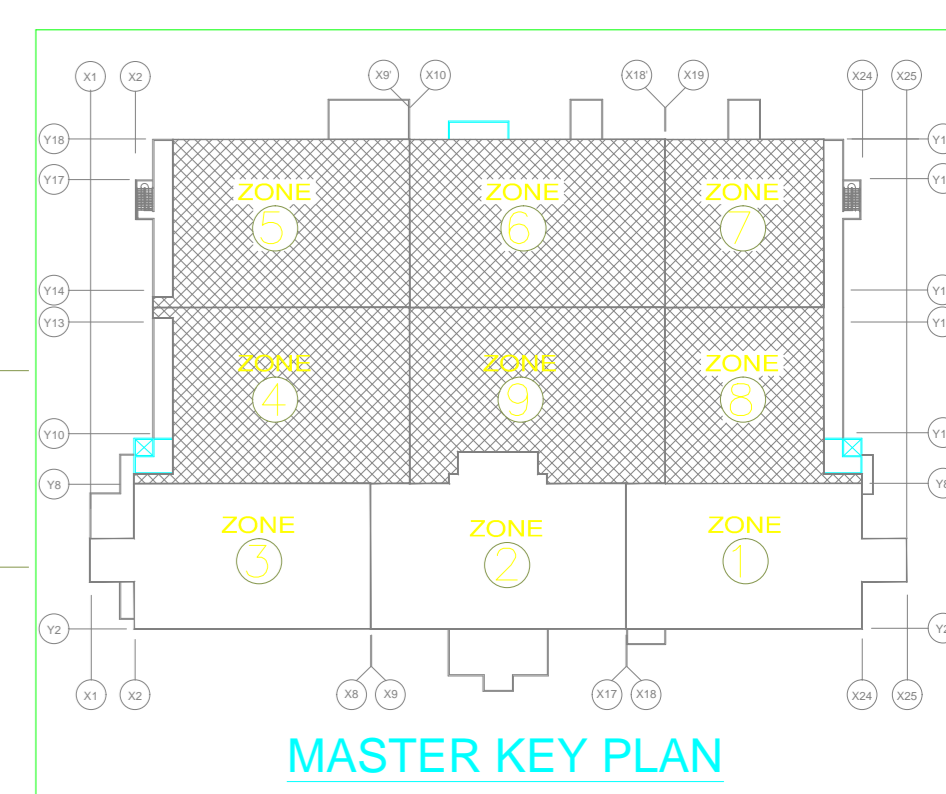

NO.	DATE	DESCRIPTION	CODES	REVISED BY
01	12/28/2009	SUBMIT FOR APPROVAL		

REVISIONS

Sheet Title			
MAIN BUILDING SECOND FLOOR PLAN ROOF DECK HVAC, EXHAUST FAN POWER & CABLE TRAY LAYOUT SHOP DRAWING			
DATE	AUTOCAD BY	CREATED BY	SHOP DRAWING BY
12 AUG. 2009	SAUD	ENG. A. ELGHWI	ENG. M. SHEPL
SCALE	1/2000	DISCIPLINE	MB-EL-104A
CONTRACT	SD-01	PROJECT	SD-EL-MB-718-00
ELECTRICAL			